



REFRIGERATION TECHNOLOGIES

# INSTALLATION MANUAL

## “STA” PLUG-IN UNITS (CABINET COOLING PLUG-IN UNITS)



**CATERING**  
Cooling Plug-in Units



# DIMENSIONS

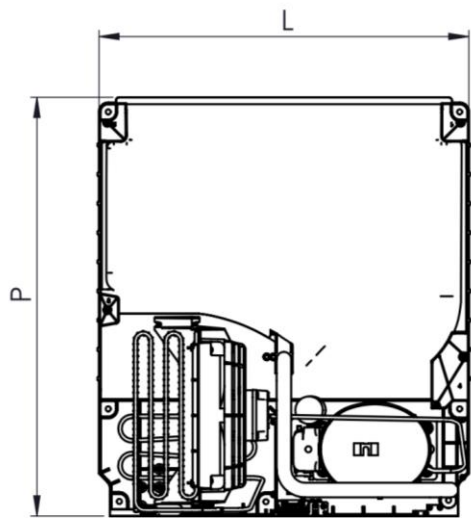

Img 1.1

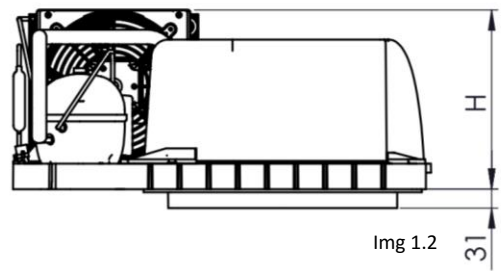

Img 1.2

L	P	H	Application
609	688	295	TN
609	688	330	BT

Monoblocco / Plug-in unit

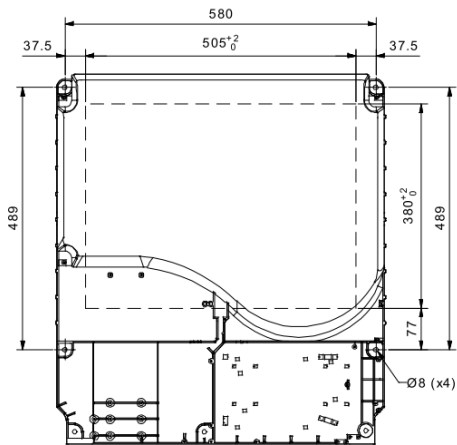

Img 2.1

Armadio / Cabinet

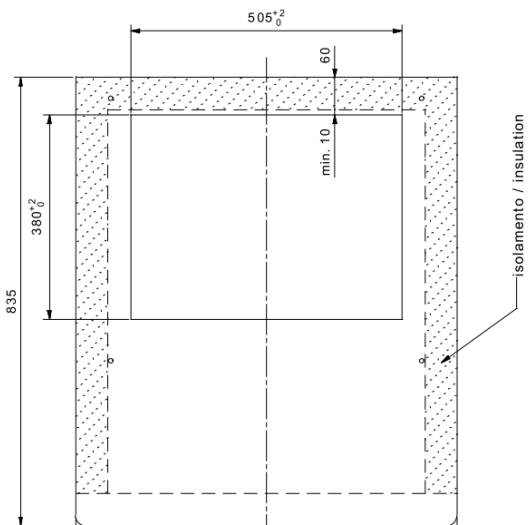

Img 2.2

## STA PLUG-IN UNITS INSTALLATION

### CABINET CEILING: RECTANGULAR HOLE DIMENSIONS

External face of the cabinet ceiling:

- Cut a rectangular hole of  $505^{(+2)} \times 380^{(+2)}$  mm on the external face of the cabinet ceiling metal sheet and keep cutting in the expanded polyurethane layer up to the internal metal sheet, making sure that the latter remains intact. Cut a thin fissure around the hole in order to interrupt the thermal bridge between warm/cold ambient and avoid condensation forming. Drill N°4 holes as illustrated in the drawings here below to fix the unit on the cabinet.

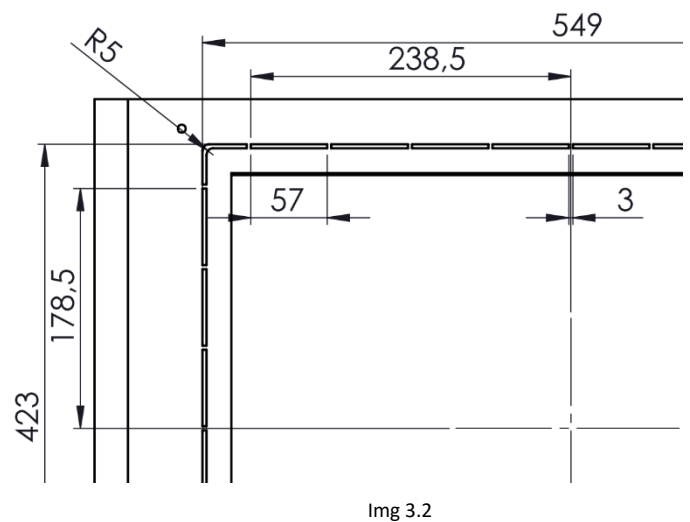
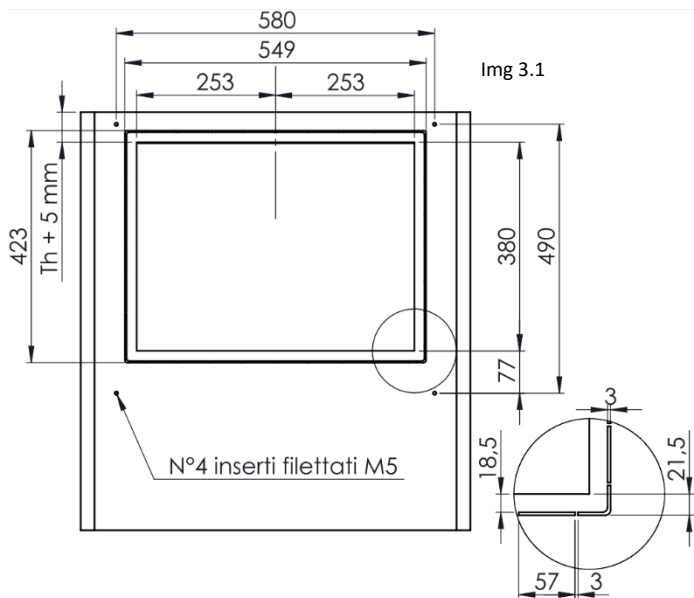

Internal face of the cabinet ceiling:

- Make the ventilation openings by cutting two contiguous rectangular holes (230x55mm/each) for air outlet and a grill (468x188mm) for air intake. Please refer to the dimensions indicated here below.

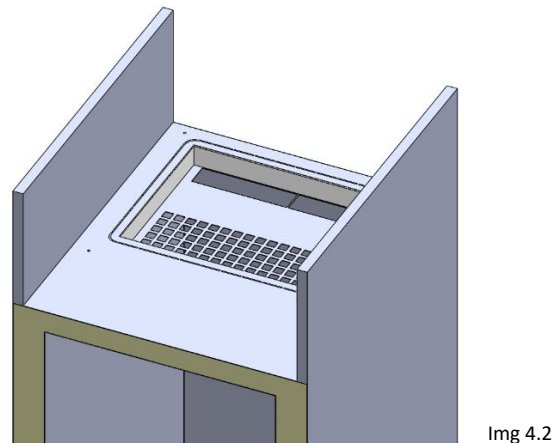
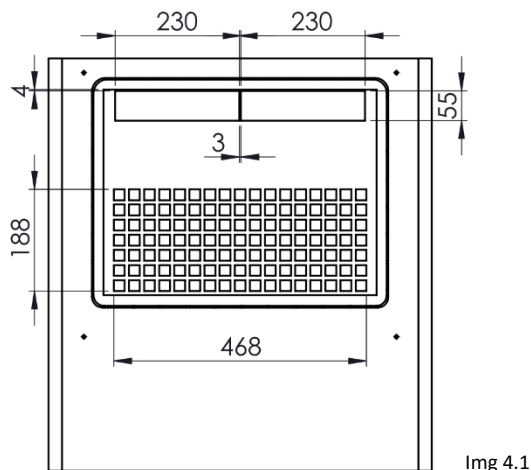

- Inlet/outlet partitioning insert

This item is necessary to avoid air recirculation between air inlet and air outlet.

We suggest to create an insert following below instructions and to fix it to the internal metal sheet.

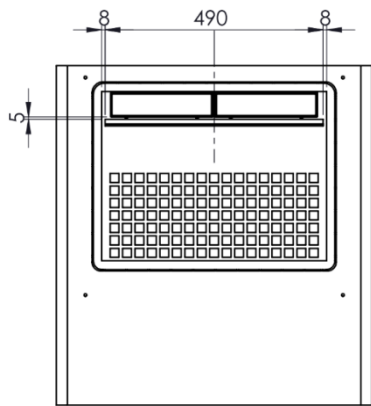

Img 5.1

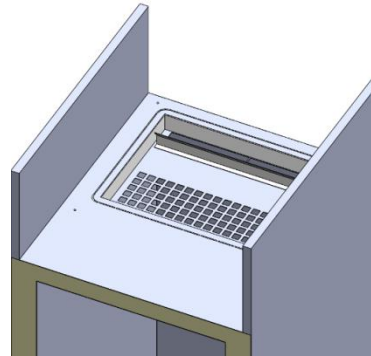
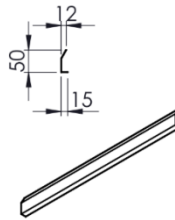

Img 5.2

## SUGGESTIONS

- TECO air conveyors

The installation of TECO air conveyors is recommended. This ensures a good air flow through the air outlet opening (air conveyors are supplied as an optional). These conveyors make air flow easier and they also protect the final user from potentially dangerous sharp edges.

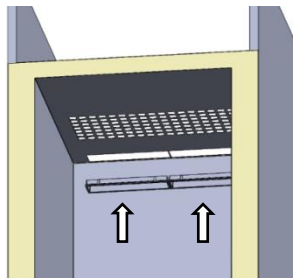

Img 6

- Styrofoam frame

Before foaming the cabinet, we suggest to place a frame made of expanded material around the 505(+2)x380(+2)mm rectangular hole between the external and the internal metal sheets, in order to delimit polyurethane expansion during the foaming process.

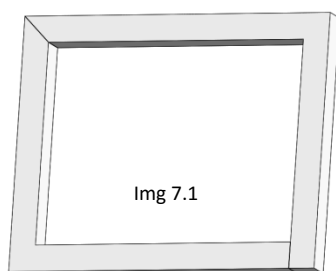

Img 7.1

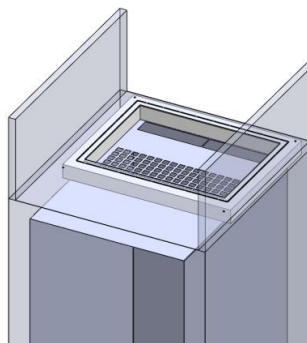

Img 7.2

## HOW TO FIX THE PLUG-IN UNIT ON THE CABINET

- Place the plug-in unit on top of the cabinet and align it to fixing points and ventilation openings, then fasten it with N°4 M5 screws.

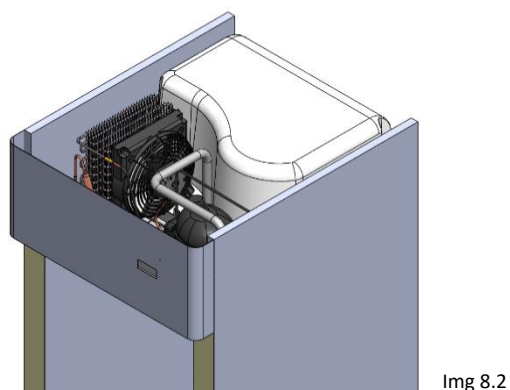
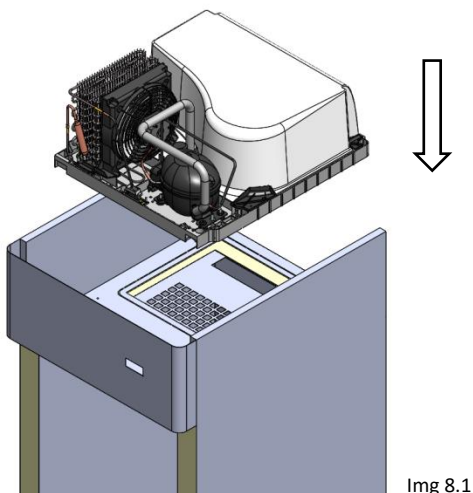

## Electrical wiring

Connect the plug-in unit to the thermostat and to the electric power through the 8-pin male port connector located on the plug-in base. The 8-pin connector allows powering all components separately.

- *Compressor*
- *Condenser fan*
- *Evaporator fan*
- *Defrost*

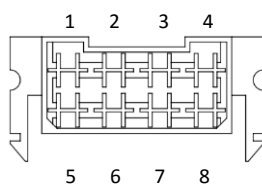

- 1 \_ Compressor neutral
- 2 \_ Condenser fan neutral
- 3 \_ Evaporator fan neutral
- 4 \_ Defrost neutral
- 5 \_ Compressor phase
- 6 \_ Condenser fan phase
- 7 \_ Evaporator fan phase
- 8 \_ Defrost phase

